

# MINIUM STANDARDS FOR DRIVEWAYS AND OFF-STREET PARKING TOWN OF TRAIL CREEK, INDIANA

## Driveway and Off-Street Parking Areas:

Driveways and off street parking areas shall be installed in such a manner as to not interfere with the flow of storm water adjacent to the traveled roadway.

Elevations shall be taken along the edge of the pavement, adjacent swale, along front lot lines across the entire parcel of land at ten (10) foot intervals in order to determine the direction of flow of storm water.

Drives shall be constructed with a negative gradient or down slope from the edge of the pavement at a rate of not less than one (1) inch per foot for not less than five (5) feet from pavement edge. From this point the drive shall slope upward at a positive gradient to the garage floor, parking area pad or front lot line.

Off street parking areas shall be constructed as outlined above with the exception of the upslope or positive gradient ending at the street right-of-way line.

All construction within the street right-of-way shall be not less than the following:

### For asphalt drive or parking area:

6" of # 53 compacted aggregate base either limestone or slag aggregate  
2" of 19mm intermediate hot mix asphalt binder  
1" of 9.5mm hot mix asphalt surface

### For concrete drive or parking area:

6" of Type "A" 3600 psi Portland Cement concrete pavement – reinforcement shall be  
6" x 6" x 6 gauge welded wire fabric or approved equal

In no case shall the installation of the driveway of off-street-parking area impede the flow or drainage

All construction is subject to the approval of the Town Engineer Mr. John Doyle or Street Commissioner Mr. Jeff Bruder

**I, the undersigned, Understand, Mr. John Doyle (219) 872-2221 is to be contacted BEFORE and AFTER construction is complete.**

Signature: \_\_\_\_\_

Date: \_\_\_\_\_

MINIMUM STANDARD FOR DRIVES  
AND OFF-STREET PARKING AREAS  
TOWN OF TRAIL CREEK, INDIANA

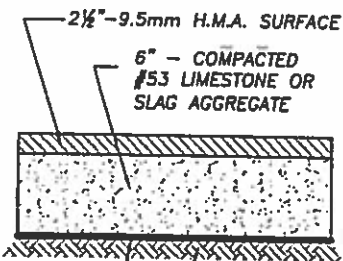
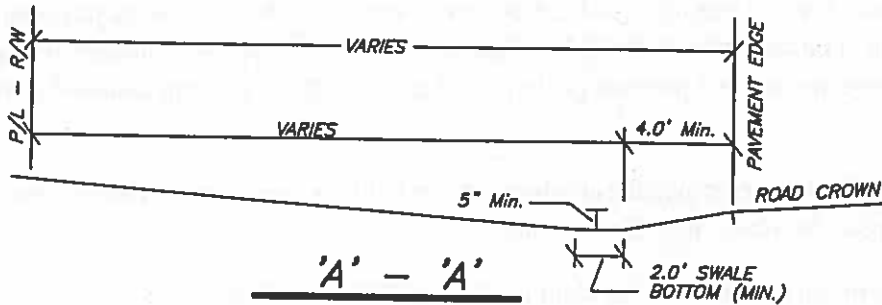
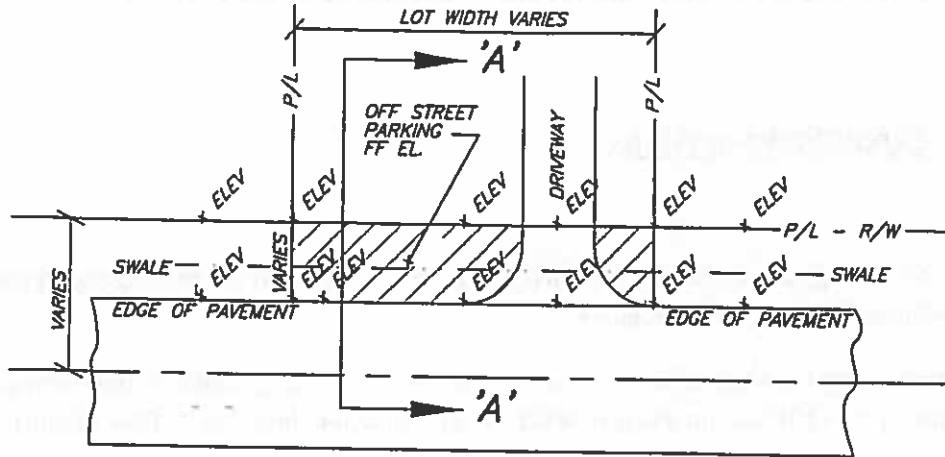

COMPACTED SUB-GRADE -  
Compact to 95% of it's maximum  
density in accordance with the  
latest requirements of ASTM 1557D.

**ASPHALT SECTION**

NO SCALE

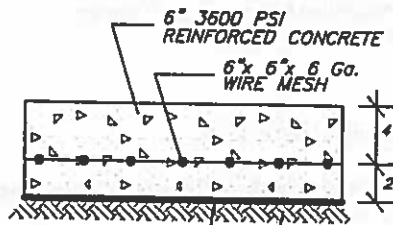

COMPACTED SUB-GRADE -  
Compact to 95% of it's maximum  
density in accordance with the  
latest requirements of ASTM 1557D.

**CONCRETE SECTION**

NO SCALE

Approved by the Town Council of Trail Creek, Indiana this \_\_\_\_\_ day of \_\_\_\_\_, 2012

TOWN COUNCIL

\_\_\_\_\_  
PRESIDENT

\_\_\_\_\_  
VICE PRESIDENT

\_\_\_\_\_  
MEMBER

\_\_\_\_\_  
MEMBER

\_\_\_\_\_  
MEMBER

\_\_\_\_\_  
ATTEST - TOWN CLERK